

MVM PLUS C



Volumetric Water
Meter
Composite Body
For Potable Water
Residential Use
R400

General Introduction

Volumetric composite meter, sizes DN 15, 20, and 25, R400, with magnetic transmission and dry register for potable water use. The technical requirements for manufacturing materials comply with the guidelines of Resolution 0501 of 2017 issued by the Ministry of Housing, City, and Territory.

Characteristics

- Extremely low starting flow and wide measuring range allow for full consumption accounting and facilitate leak detection
- Rotary piston volumetric meter for cold water
- Ideal for public utilities and outdoor installations
- Can be installed in any position while maintaining metrological performance
- High protection against external magnetic fields
- Hermetically sealed register (copper-glass IP68) that completely eliminates condensation risk and ensures optimal readability
- 360° rotatable register
- Reinforced composite housing
- Can be supplied equipped with radio or wired communication module
- Pre-equipped for static pulse emitter (1P = 1L)

Technical information

Performance under extreme conditions: Suitable for operation under maximum pressure conditions of 16 bar

Accessory description: Includes a set of couplings for installation

Packaging recommendations: Packaging unit of 10 meters to optimize transport and storage

Lubricant recommendations: N/A

Description of tests to evaluate hydraulic performance: Tests and trials carried out in accordance with NTC ISO 4064.

Preventive and corrective maintenance instructions: No maintenance required

Technical regulation or standard: NTC ISO 4064

Service life: Minimum of 10 years based on material durability

Technical Characteristics

Diameter	mm	15	20	25
	Inch	½	¾	1
Q₃	m ³ /h	2,5	4	6,3
Q₄	m ³ /h	3,13	5	7,88
R	400			
Q₁	l/h	6,25	10	15,75
Q₂	l/h	10	16	25,20
Maximum permissible error between Q1 and Q2 (excluded)		+/- 5%		
Maximum permissible error between Q2 (inclusive) and Q4		+/- 2% With water temperature ≤ 30 °C +/- 3% With water temperature > 30 °C		
Temperature class		T30,T50		
Flow profile sensitivity class		U0 - D0		
Starting flow rate	l/h	0,5	1	2,5
Pressure loss		ΔP63		
Working pressure	bar	16		
Maximum reading	m ³	99.999		
Minimum reading	l	0,02	0,002	0,02
Indicative weight	kg	0,450	0,9	1,3

Maximum Permissible Error

For Q1 inclusive up to, but excluding Q2: ±5%

For Q2 inclusive up to and including Q4: ±2% for T30

Typical Curve

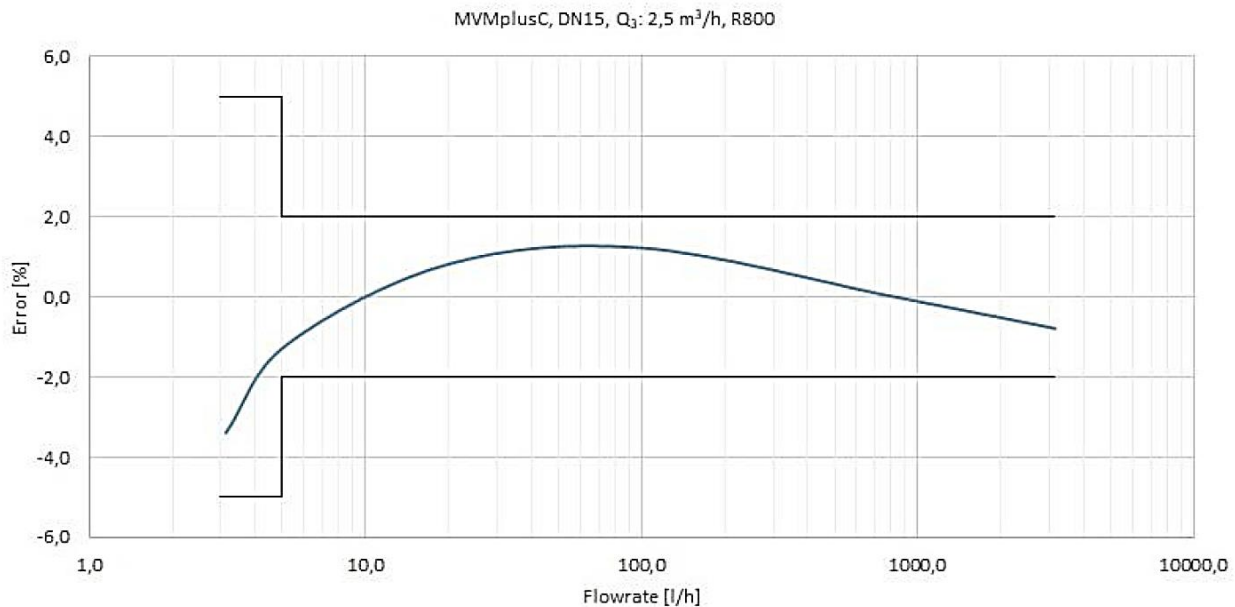

Pressure Loss Curve

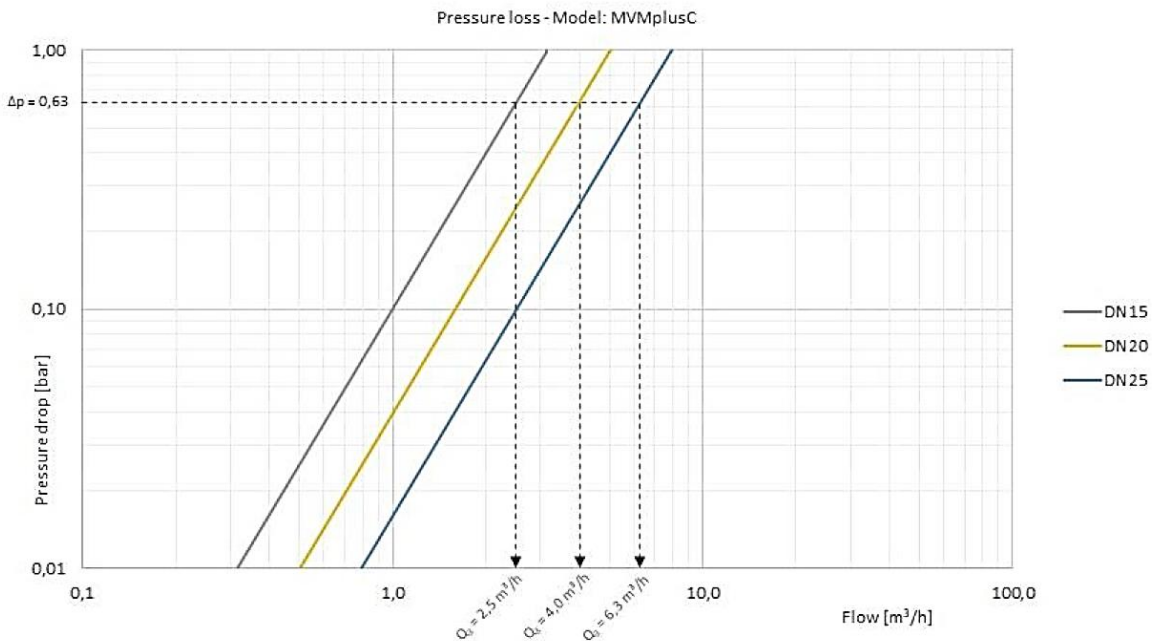

Certifications



Certificado No. CPC-07500-1-B-19
Esquema 5

Dimensions

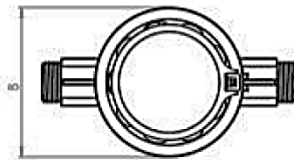
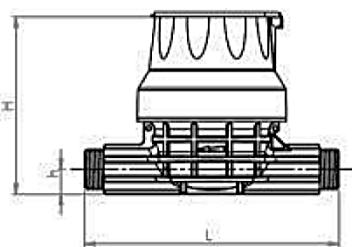

Diameter	mm	15	20	25
	Inch	1/2	3/4	1
Thread	Inch	G 3/4 B	G 1 B	G 1 1/4 B
L	mm	110/115/165/170/190	165/190	178/260
H	mm	115	127,5	148,5
h	mm	16	20	30
B	mm	94	108	135

DOCUMENT'S VERIFICATION AND APPROVAL

